

SMART-ABI SYSTEM

WHY SMART-ABI?

WHO SHOULD BE TESTED?

**EARLY DIAGNOSIS +
TIMELY TREATMENT =
LESS SURGERY &
HOSPITALIZATION**

The Smart-ABI system is indicated for use on adult subjects at risk of having or developing peripheral arterial disease (PAD).

Wireless, Bluetooth, Smart Technology



ABI is an indicator of atherosclerosis at other vascular sites and the exam is recommended by International Heart Associations.

- 75% of all patients with PAD are asymptomatic.
 - 1-MINUTE TEST
 - Simple decision tree
- Normal → Borderline → Severe - Send to C.V.
- Easy to read reports - Quantifiable
 - Unique marketing opportunities – Vascular health screening pays
 - Repeatable, reproducible, standardized test
 - Reduce Surgery and Hospitalization – meets MIPS requirements
 - Track and follow patient PAD over time
 - ABI specific CPT Codes 93922 & 93923

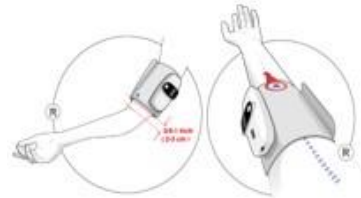

70+

50+

Population over 50 years old with cardiovascular risk factor.



Hypertensive



Overweight



Smoker



Diabetic

If a patient answers “YES” to any question on PAD test health survey.

**EVERYONE AT RISK SHOULD
BE MEASURED, MANAGED
& FOLLOWED WITH THE SMART-ABI**

SMART-ABI SYSTEM
Technology Leader

SMART-ABI Results

- Quantifiable Results vs. Wave Forms
- 3 Additional PAD Markers
- Patient Friendly Report

- Trend Results Over Time
- Manage Your Patients Disease Progression

CENTRAL AORTIC SYSTOLIC PRESSURE

Central Aortic Systolic Pressure Marker of the pressure at the aorta.	(mmHg)	111	NORMAL	116	121
Peripheral Augmentation Index Marker of aortic stiffness.	(%)	51	NORMAL	75	100
ba Pulse Wave Velocity Marker of lower extremity arterial stiffness.	(cm/s)	933	NORMAL	1550	1800

BLOOD PRESSURE MEASUREMENTS

TRENDS AND GUIDELINES



1.39 or more	1.39 - 1.00	0.99 - 0.91	0.90 - 0.81	0.80 - 0.51	0.50 or less
Non-compressible	Normal	Acceptable	Borderline	Abnormal	Severe

GRAPHICS OF SEGMENTAL VOLUME PLETHYSMOGRAPHY



DISCLAIMER: All results should be considered within the clinical context of the patient's case, history, symptoms, known diagnosis, findings from other diagnostic studies, current medications, treatment plan and therapies. The interpretation of the results is the responsibility of the medical doctor.

ABI Value	Interpretation	Recommendation
Greater than 1.39	Calcification / Vessel hardening	Refer to vascular specialist
1.0 - 1.39	Normal	None
0.91 - 0.99	Acceptable	Treat risk factors
0.81 - 0.90	Moderate Peripheral Artery Disease	Treat risk factors and Medication Acetylsalicylic Acid low dose
0.6 - 0.8	Defined Peripheral Artery Disease	Refer to vascular specialist
Less than 0.6	Severe Peripheral Artery Disease	Refer to vascular specialist

PHYSICIAN'S NOTES

- Include Exam Notes
- Send Directly to Your Server or EMR

DISCLAIMER: All results should be considered within the clinical context of the patient's case, history, symptoms, known diagnosis, findings from other diagnostic studies, current medications, treatment plan and therapies. The interpretation of the results is the responsibility of the medical doctor.

Segmental Volume Plethysmography

OUR ABI RESULTS HAVE BEEN COMPARED WITH THE DOPPLER MEASUREMENT METHOD.